

Piney Branch ES

FEASIBILITY STUDY

City of Takoma Park Meeting

APRIL 23, 2025

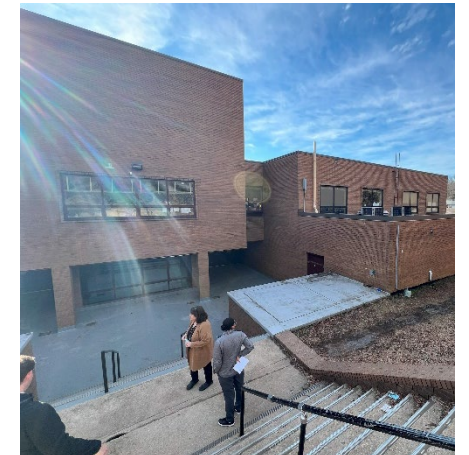
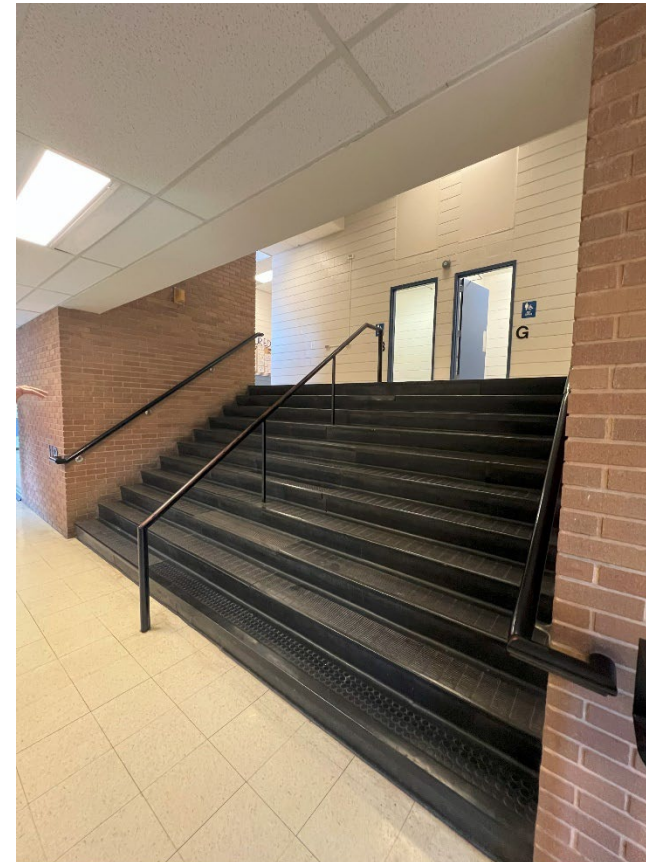
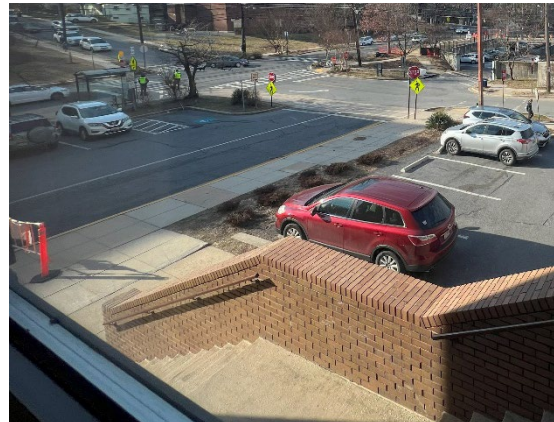



Agenda

1. Introductions
2. Schedule
3. Communications
4. Feasibility Study
5. Design Options
6. Funding

**The boundary study will not be discussed during this meeting*



1

Introductions



Meet Montgomery County Public Schools

Point of Contact



**Julie
Morris**

DIVISION OF DESIGN +
CONSTRUCTION

*Director,
Division of Planning,
Design and Construction*



**Robbie
Badstibner**

DIVISION OF DESIGN +
CONSTRUCTION

*School Facilities,
Project Manager*



**Erika
Dworkin**

DIVISION OF CAPITAL
PLANNING AND REAL ESTATE

*School Facilities,
Planner II*

240-740-7737

Robbie_S_Badstibner@mcpsmd.org



Piney Branch Team



Meet your Building and Educational Program Analysts



**Jasmin
McDuffie**

AIA, NCARB, LEED AP

Principal-in-Charge



**Bill
Bradley**

PHD, AIA, LEED AP, ALEP

Educational Planner



**Carolyn
Frederick**

AIA, LEED AP BD+C

Sr. Project Architect



**Tom
Foley**

RA

Design Architect



**Chesenia
Burgos**

IIDA, NCIDQ

Sr. Interior Designer



**Brandon
Dennis**

Designer



Piney Branch Team – About Stantec



PINEY BRANCH ELEMENTARY SCHOOL FEASIBILITY STUDY

230
Elementary
Schools
(Past 10 yrs.)



1,350
Total K12 Projects
(Past 10 yrs.)

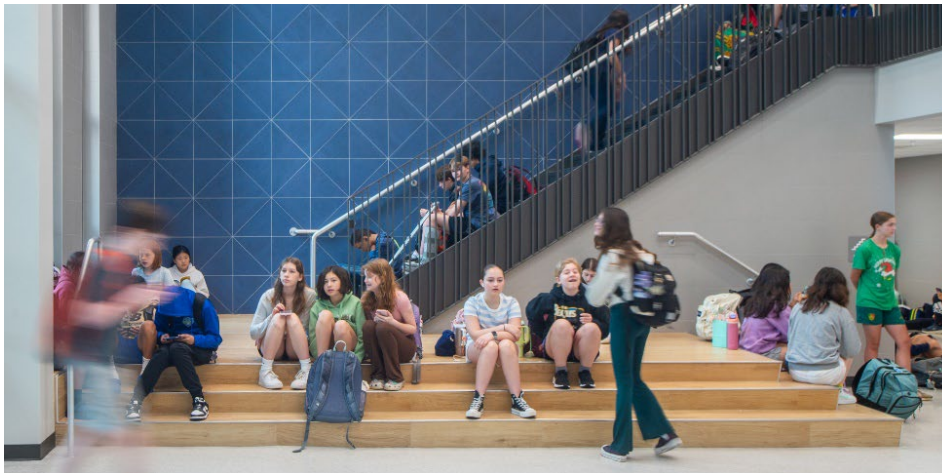

85+
LEED
Schools
(Past 10 yrs.)



\$3M
annual
investment in
R+B

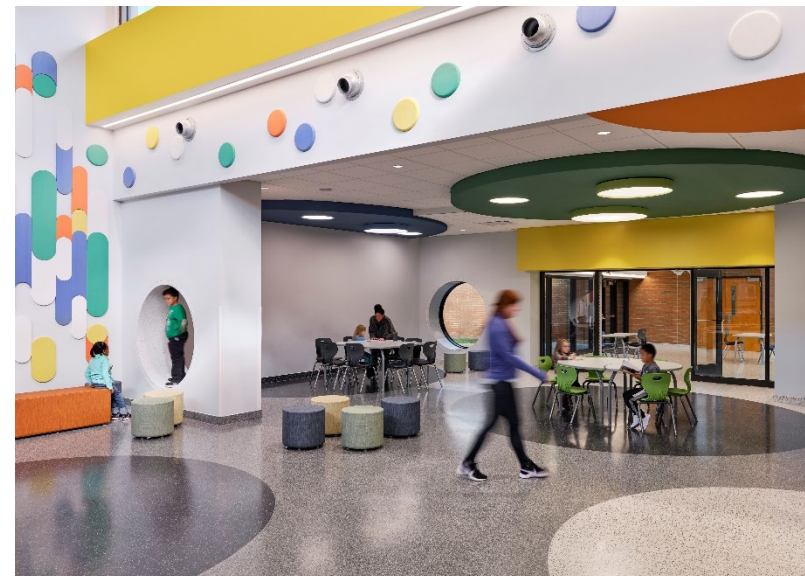

100+
Design Awards
(Past 10 yrs.)



Piney Branch Team



Meet your Site and Building Systems Analysts

Civil:

Structural:

MEP / FP:

Pool Consultant:

Cost Engineering:



TYLin



LANDMARK
AQUATIC



Clark Azar

TYLin

James Posey
& Associates

Landmark
Aquatic

Downey &
Scott, LLC



2

Schedule



Schedule

1. **April 23, 2025 (today):** City of Takoma Park meeting
2. **May 1, 2025:** Community meeting #1
3. **May 15, 2025:** Community meeting #2
4. **May 27, 2025:** Community (staff) meeting
5. **May 29, 2025:** Community meeting #3
6. **June 4, 2025:** Community meeting #4

April

May

June





Schedule

1. April 23, 2025 (today): City of Takoma Park meeting
2. May 1, 2025: Community meeting #1
3. May 15, 2025: Community meeting #2
4. May 27, 2025: Community (staff) meeting
5. May 29, 2025: Community meeting #3
6. June 4, 2025: Community meeting #4

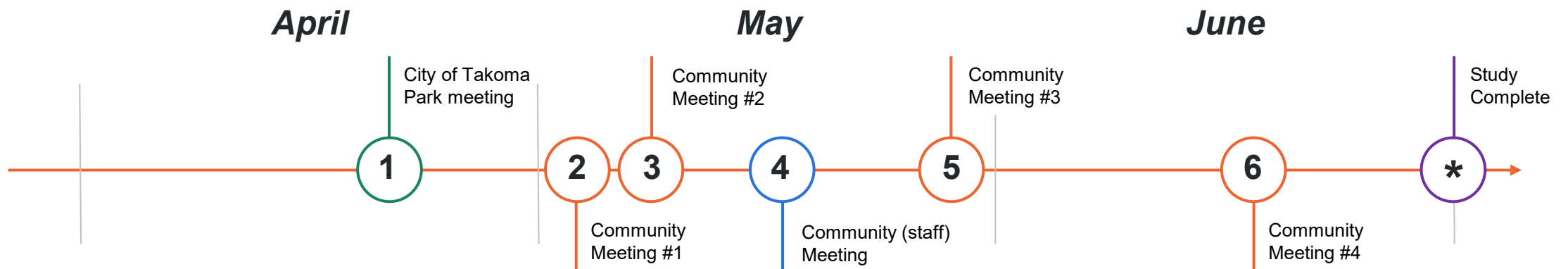



3

Communications



How We Will Notify the Community



Send Over 300
Mailers With Dates



Post
Signage



Advertise in City's
Monthly Newsletter



Advertise on
School's Website



4

Feasibility Study



Why?

An FY23 appropriation was approved to begin the architectural design for a major capital project at Piney Branch ES; however, no construction funds were included in the adopted FY23-28 CIP.

During the review of the Takoma Park Minor Master Plan Amendment, it was approved as part of the FY25-30 CIP that planning be postponed until the Master Plan Amendment process was complete.

Now that the County Council has approved the Takoma Park Minor Master Plan Amendment, a feasibility study for a major capital project at this school has been recommended.



What?

A comprehensive feasibility study will provide a quantifiable set of next steps for Piney Branch thereby taking the guess work out of the design process.

The study will explore multiple options for the facility and provide cost estimates for each that will help to inform the Superintendent's recommended CIP in the fall of this year.



Feasibility Study Process

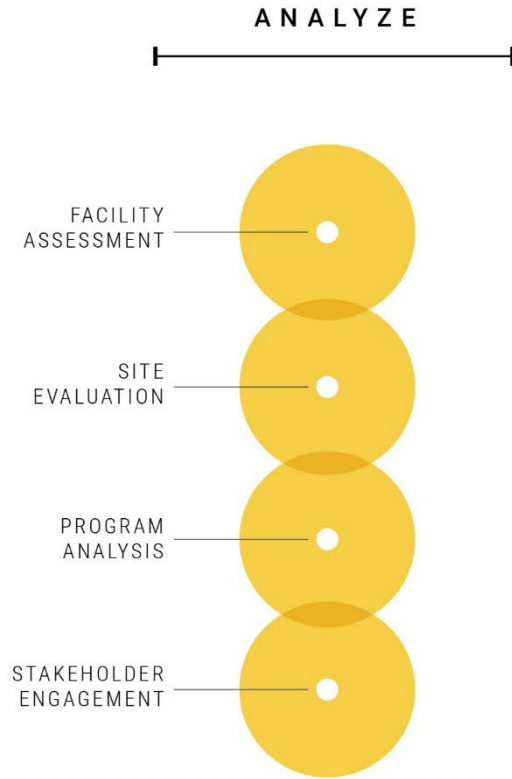



Feasibility Study Process

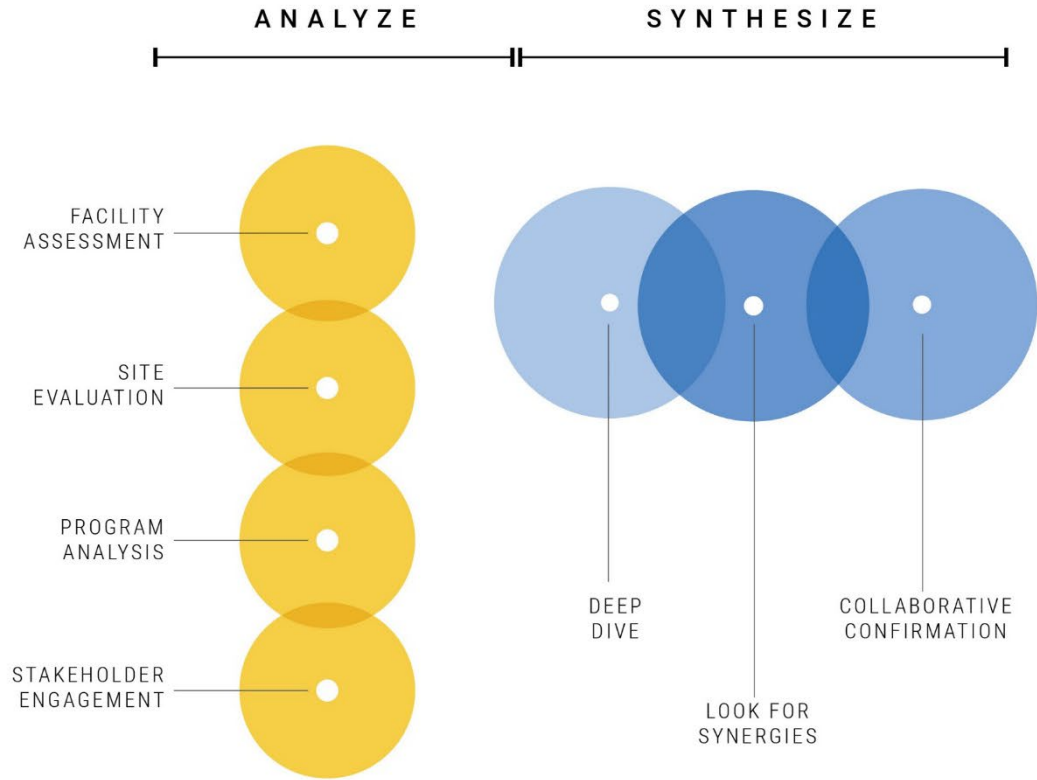



Feasibility Study Process

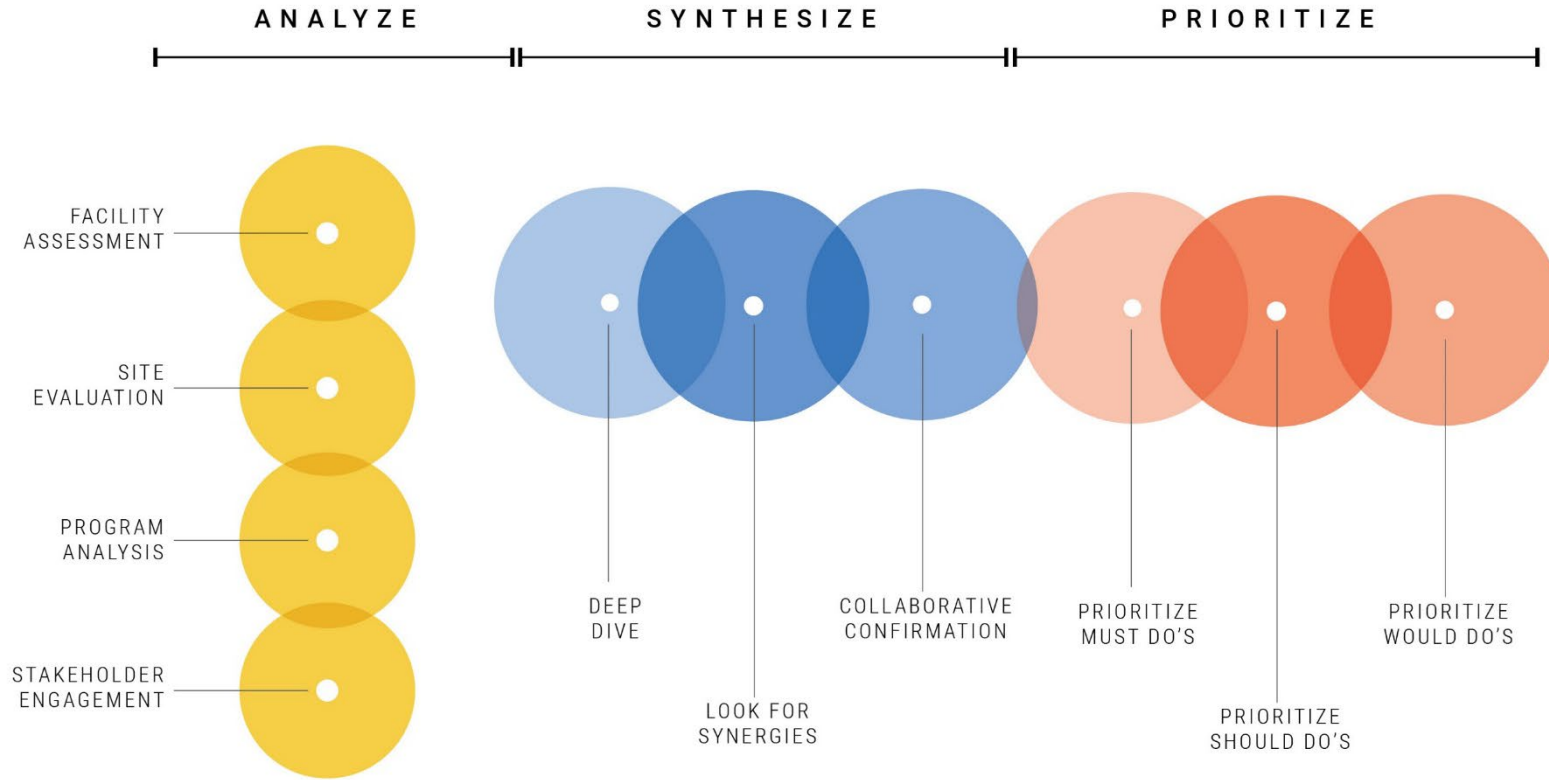



Feasibility Study Process

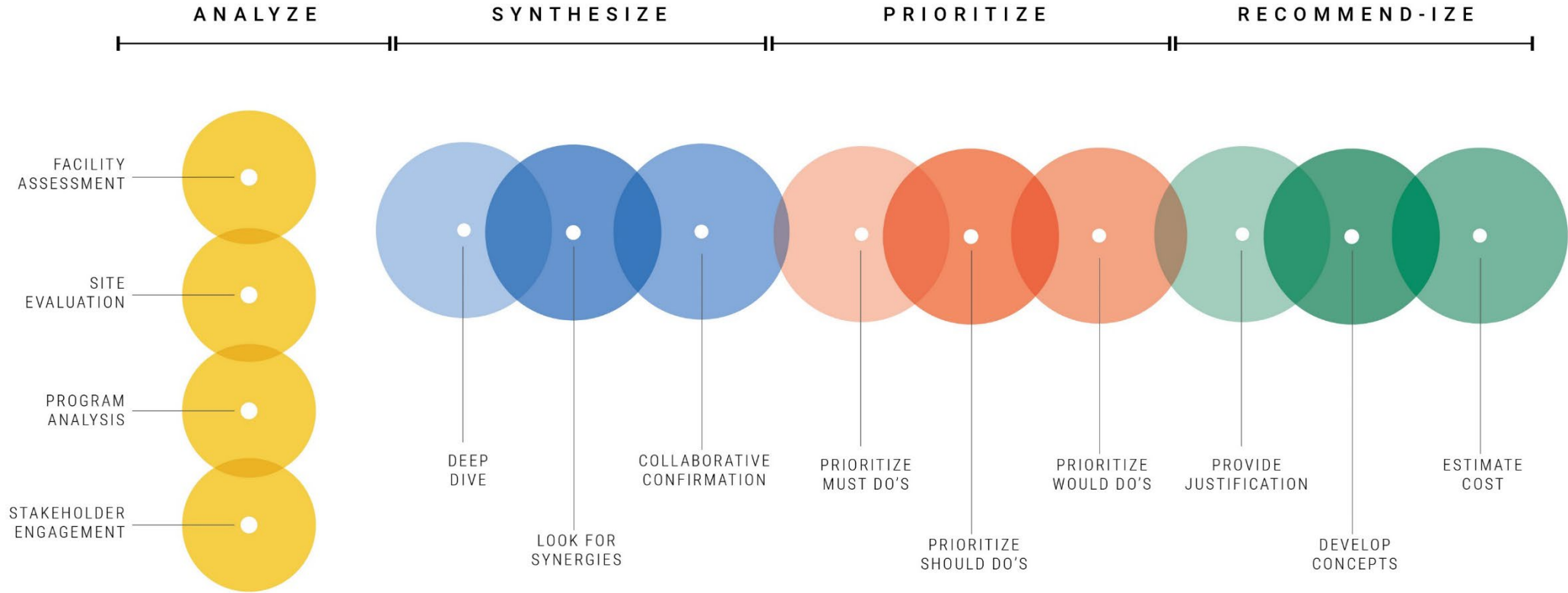



Feasibility Study Process

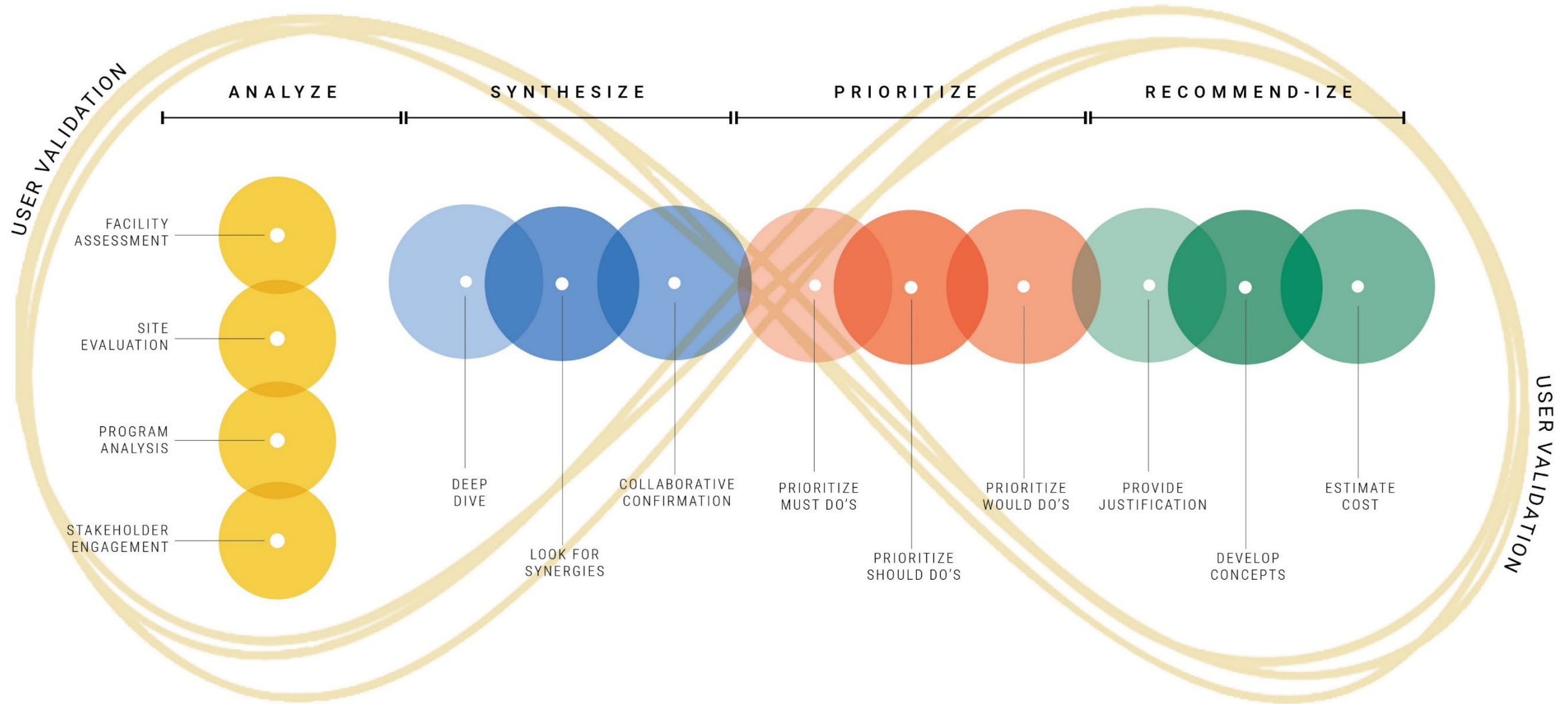



The Process...Engaging the Community

- Being Asked
- Being Informed
- Proposing Solutions
- Making Recommendations
- Supporting Quality Public Education





5

Design Options



Existing School and Site





Design Options



1.

Full Renewal
of the Existing
School

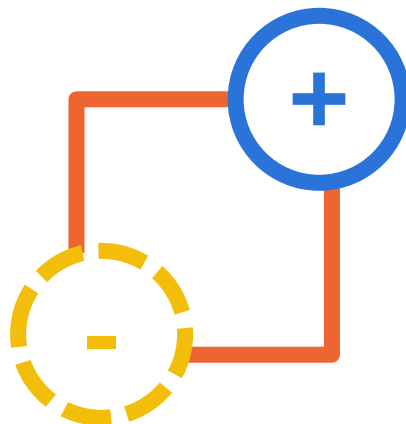

2.

Full Renewal of Existing
School + Addition
(<50% demolition)

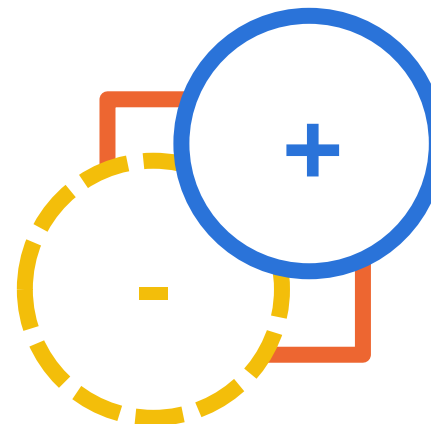

3.

Full Renewal of Existing
School + Addition
(>50% demolition)

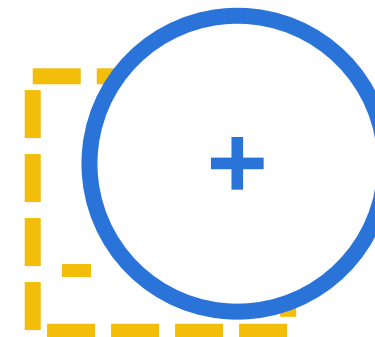

4.

Demo Existing School
+ Build New School
(on existing site)



6

Funding & CIP Process



Funding & CIP Process

Key Dates

1. **BOE Recommendation in November 2025**
2. **Montgomery County Council approval May 2026**
3. **Design and Construction funding available after July 1, 2026 (TBD)**



Funding & CIP Process

Key Dates

1. BOE Recommendation in November 2025
2. Montgomery County Council approval May 2026
3. Design and Construction funding available after July 1, 2026 (TBD)

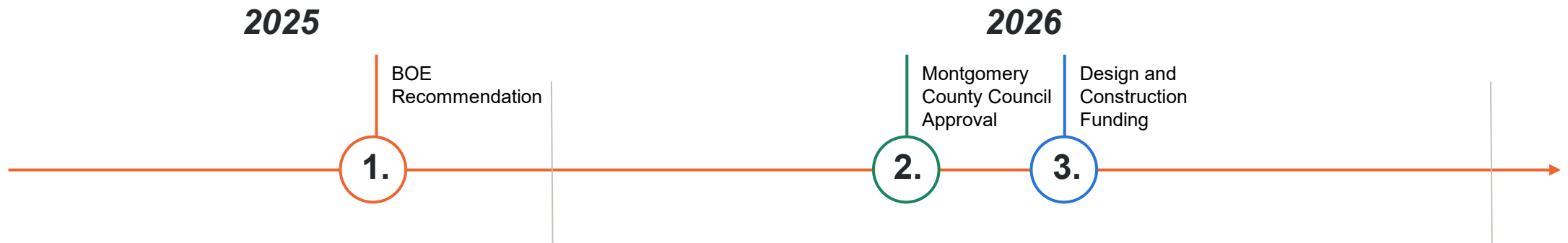

THANK YOU
QUESTIONS?





Piney Branch ES

FEASIBILITY STUDY

City of Takoma Park Meeting

APRIL 23, 2025

