

April 4, 2013

DATE

PROJECT : Wayside Elementary School Modernization
Schematic Design - Community Meeting #2

PROJECT NO. : 530275.000

CC : Shawn Benjaminson
Cindy Ponafala
Phill Brummett
FILE
☐ ATTACHMENTS

<u>ATTENDEES</u>	<u>COMPANY/TITLE</u>	<u>PHONE</u>	<u>EMAIL</u>
Courtney Jones	WES Asst. Principal	301-279-8484	Courtney_m_jones@mcpsmd.org
Jim Tokar	MCPS DOC – Project Manager	240-314-1008	James_R_Tokar@mcpsmd.org
Zach Larnard	MCPS DLRP - Planner	240-314-1000	Zachary_larnard@mcpsmd.org
Dena Schoenfeld	WES - PTA	240-277-6507	denaschoenfeld@gmail.com
Ioanna Chase	WES	301-279-8484	Ioanna_Chase@mcpsmd.org
Taryn Schaffer	WES - Parent		tarynschaffer@gmail.com
Cheryl Sheer	WES - Parent		CherylSheer@gmail.com
Alejandra Mercado	WES - Parent		Alejandra.mercado@gmail.com
Marlon Roxas, AIA	WES - Parent		Marlon.roxas@gmail.com
Robert Cryer	WES - Neighbor		bccryer@verizon.net
Diane Boyd Rauber	WES - Neighbor	301-251-9211	dbrauber@comcast.net
Andrew Rossi	WES	240-328-6091	Rossia@mail.nih.gov
Dimas Chavez	WES - Neighbor		dimasmiranc@aol.com
Mirian Chavez	WES Neighbor		dimasmiranc@aol.com
Bill Brown	Moseley Architects	703-249-7640	bbrown@moseleyarchitects.com
Olivia Brookman	Moseley Architects	703-249-7629	obrookman@moseleyarchitects.com
Molly Merlo	Moseley Architects	703-249-7663	mmerlo@moseleyarchitects.com

These meeting notes reflect the notes and memory of the writer and constitute the basis on which the project is proceeding. Any clarifications, corrections, or additions should be submitted to Moseley Architects in writing within seven days of receipt of this document.

<u>ITEM</u>	<u>DESCRIPTION</u>	<u>ACTION BY</u>
1.	Mr. Tokar called the meeting to order at 7:00 pm. He gave an overview of the process and had all present introduce themselves.	-- --
2.	Mr. Lanard briefly reviewed the latest MCPS educational specification for Wayside ES. The spaces to be provided in this modernization include; 4 Kindergarten classrooms, 12 standard classrooms, a new Admin suite and Health Suite, Media center, Multi-purpose room and kitchen, Art Room, Dual Purpose Room, Music Room, Instrumental Music Room, Gymnasium, PEP classrooms, SCB classrooms and support spaces including Resource Rooms, Instructional support rooms etc... Enrollment at this school has stayed the same in recent years. The school will be designed for 640 students with a core capacity of 740. Construction is scheduled to be completed in August of 2016. The students will leave for Radnor in Jan of 2015 and will return to the modernized school in August of 2016. The architects will preplan a location for 4 future classrooms.	-- --

ITEM DESCRIPTION

**ACTION
BY**

3. Mr. Brown presented the drawings. He explained that these meetings are sequential and do build on each other. Meetings are at alternating times to allow participation by both the community and the school.
- Mr. Brown mentioned that a feasibility study was done last year to make sure that the program for Wayside fits on the site. Out of 3 schemes a preferred option was identified and placed in the queue for funding. The current phase which is Schematic design is building on the preferred option identified last year.
- The 2 story addition from a few years ago will remain and the rest of the building including the gymnasium will be demolished. This gives the design team the opportunity to relocate the Gymnasium near the play fields..
- A security vestibule is provided at the main entry and the Admin suite has clear visibility of both the bus loop and the drop-off loop.
- On site, the bus loop is fully separated from the student drop-off loop. In demolishing the existing Gymnasium, ample queuing length has been added to the student drop-off to take cars off Glen Road.
- In laying out the spaces, a conscious effort has been made to separate "noisy" areas from the "quiet" areas.
- In an effort to open up space on site, the building foot print has been reduced and a second story wing added. A preplanned shell for 4 classrooms will be located on the 2nd floor for finishing in the future when the school is over capacity A courtyard to be potentially used as an outdoor learning space is created in this design. The courtyard allows daylight into all adjacent spaces.
- A circulation loop is created on the first floor between the new and the addition. An L shaped travel path is created on the 2nd level where the new 2 story wing connects to the 2 story wing to remain.
- Mr. Brown gave an overview of the adjacencies inside the various spaces

-- --



ITEM	DESCRIPTION	ACTION BY
------	-------------	--------------

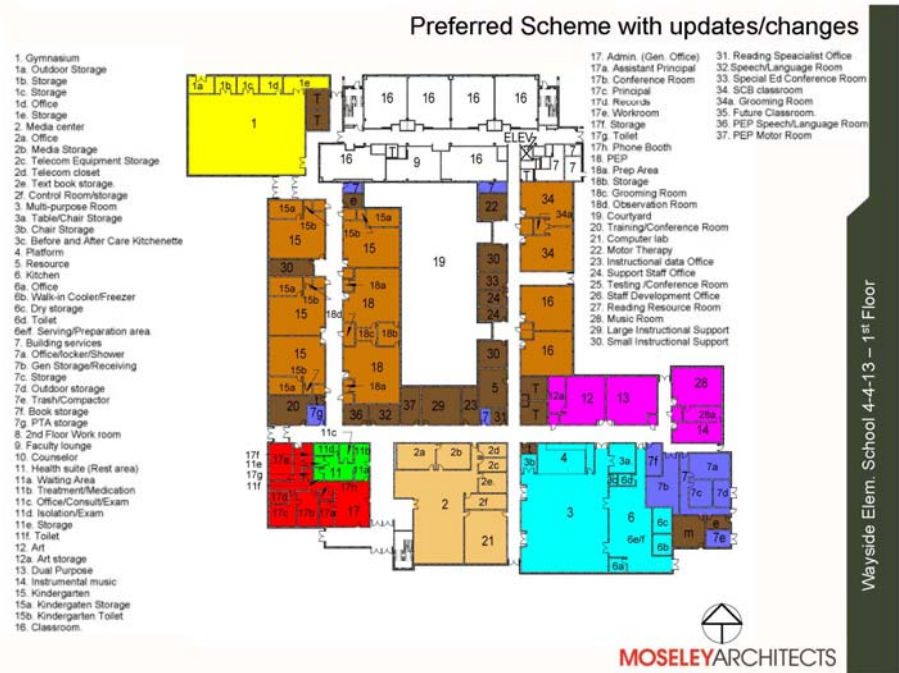
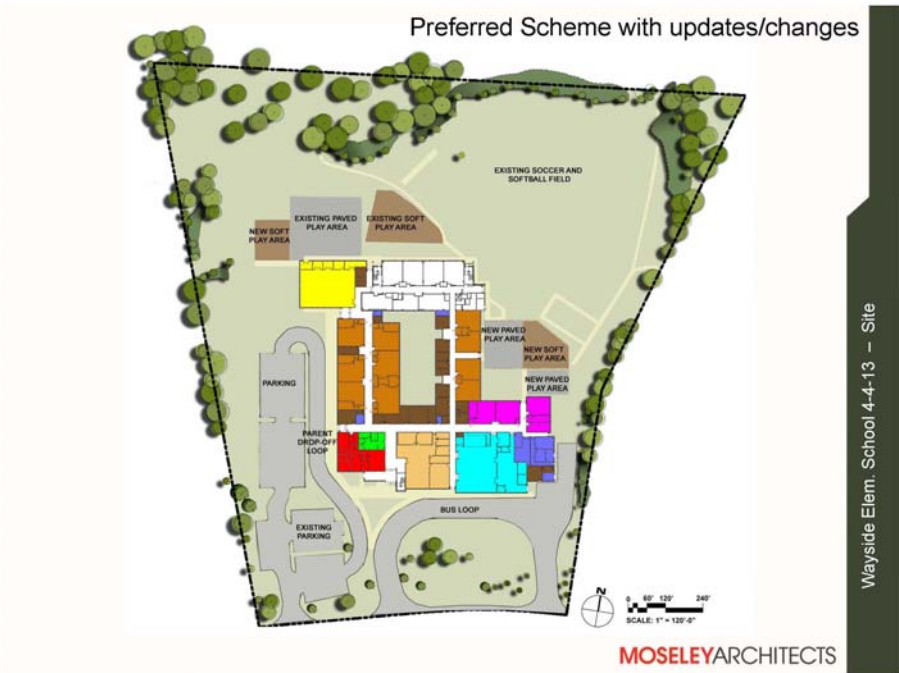

ITEM	DESCRIPTION	ACTION BY
------	-------------	--------------

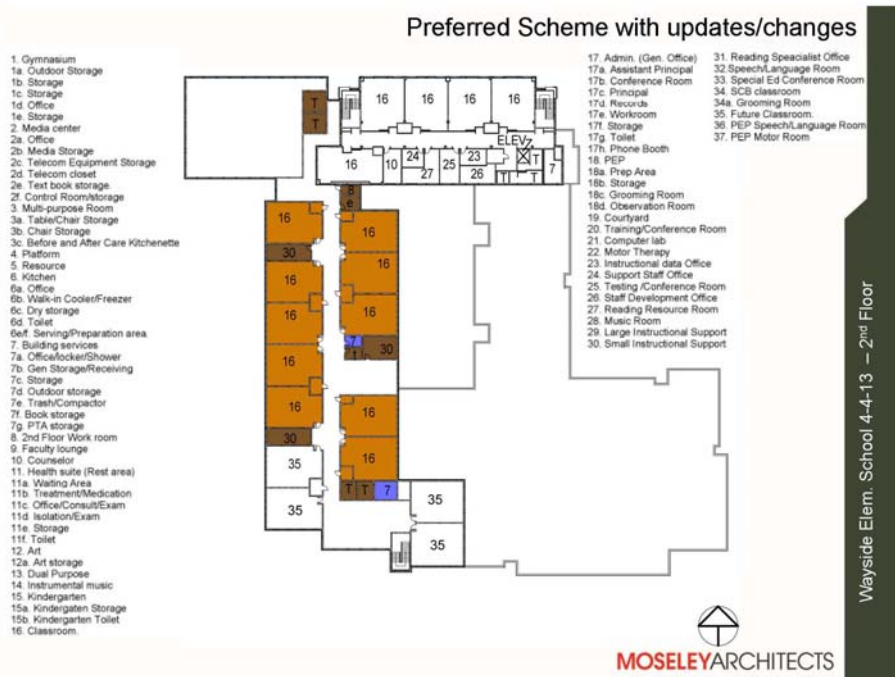

4. A neighbor stated that he does not think that the addition with its color fits in the neighborhood. He stated that he does not like the character of the addition and wants something that he feels fits in the neighborhood. Mr. Brown stated that the character of the building is a good discussion to have. He added that the design team never comes with preconceived ideas and that final layouts and building character are built on the general consensus of these meetings. Mr. Tokar added that the addition which will not be demolished went through this same process and the final outcome was based on the discussions and decisions made at those meetings at the time. -- --
5. A participant asked if the gym will be aligned with the "existing building to remain" at the back. Mr. Brown explained that is the design intent but the design team is coordinating the location and size/shape of the gym with the civil engineers to make sure that the storm water management facility is not encroached on in the process. -- --
6. A participant who is also a board member of the adjacent pool expressed concern about storm water run-off from the site dumping into their kids pool. This happened as recent as last year and would like to ask that this issue is resolved in the modernization. Mr. Tokar stated that they were under the impression that the problem had been resolved during the addition work. MCPS will work with the engineers to make sure that the problem is taken care of. -- --
7. A participant asked that the design team show an overlay of the existing building outline over the new to give them an idea of the size of the new building. -- --

<u>ITEM</u>	<u>DESCRIPTION</u>	<u>ACTION</u> <u>BY</u> -- --
8.	A participant asked about the security features in the new design. Mr. Brown explained that doors will be open for supervised student drop-off and bus drop-off in the mornings. Once the school day begins, all the doors will be locked and no one can get in from outside without having to go through the main entrance. At the main entrance vestibule the second set of doors will also be locked once class begins forcing all visitors to enter the general office and sign in before entering the school. He added that whatever additional MCPS standards/procedures are in place during design will be added to the security design for the school. Staff and administrators will monitor propped-open doors. MCPS does not currently have alarm systems for this.	
9.	A participant asked about the noise factor of the HVAC units on the existing to remain addition and if anything would be done about it. Mr. Tokar stated that the noise will be reviewed and ways to counteract it will be analyzed.	
10.	A participant asked if the site perimeter trees will be impacted. Mr. Brown stated that it is anticipated that no trees need to be cut. And in the event that it happens, stringent requirements for site work will be the reason. Additional trees will be planted if any trees are cut.	
11.	A participant asked if a stair connecting the pool and the school can be provided since they both use each other's facilities for overflow parking during events. Mr. Tokar and Mr. Brown stated that this will be considered.	
12.	A participant asked why this site was picked for a modernization when he's seen worse schools in the county. Mr. Tokar explained that all MCPS schools are rated, evaluated and ranked for repairs additions and modernizations. Wayside is one of the schools next in line to be modernized.	
13.	A student stated that his classroom is currently on the 2nd floor of the addition and barely has time to walk the distance from his classroom to the bus loop before the last call for his bus and wanted to know if anything can be done about the travel distance. Mr. Brown explained that with the reconfigured building foot print, the travel distance has been reduced and the bus loop is now closer to the addition which will remain..	
14.	Mr. Tokar thanked all present for taking time out of their day to be at the meeting.	
15.	The next meeting/work session will be on April 17th at 3:45pm.	



Olivia Brookman, LEED AP BD + C