

# MEETING MINUTES

June 2 2011

DATE

**PROJECT** : Wayside Elementary School  
Facility Advisory Committee Meeting #5  
**PROJECT NO.** : 11001.000

**CC** : Matt Willems  
Jim Leeuwrik  
Phill Brummett  
FILE  
☐ ATTACHMENTS

<u>ATTENDEES</u>	<u>COMPANY/TITLE</u>	<u>PHONE</u>	<u>EMAIL</u>
Yong-Mi Kim	WES - Principal	301-279-8484	Yong_M_Kim@mcpsmd.org
Lynn Stuart	WES Teacher	301-279-8484	lynn_l_stuart@mcpsmd.org
Donna Michels	WES Teacher	301-279-8484	donna_e_michels@mcpsmd.org
Dena Schoenfeld	Neighbor	301-299-2462	denaschoenfeld@aol.com
Ioanna Chase	WES - Admin. Secretary	301-279-8484	Ioanna_Chase@mcpsmd.org
Dennis Cross	MCPS DOC	240-314-1000	<a href="mailto:Dennis_F_Cross@mcpsmd.org">Dennis_F_Cross@mcpsmd.org</a>
Julie Morris	MCPS DOC - Planning	240-314-4713	<a href="mailto:Julie_a_morris@mcpsmd.org">Julie_a_morris@mcpsmd.org</a>
Jim Tokar	MCPS DOC – Project Manager	240-314-1008	<a href="mailto:James_R_Tokar@mcpsmd.org">James_R_Tokar@mcpsmd.org</a>
Gretchen Solender	WES - Teacher	301-279-8484	<a href="mailto:Gretchen_C_Solender@mcpsmd.org">Gretchen_C_Solender@mcpsmd.org</a>
Kathy Grosso	WES - Media Specialist	301-279-8484	<a href="mailto:Katherine_T_Grosso@mcpsmd.org">Katherine_T_Grosso@mcpsmd.org</a>
Dana Englund	WES – Special Ed. Teacher	301-774-1930	<a href="mailto:Dana_M_Englund@mcpsmd.org">Dana_M_Englund@mcpsmd.org</a>
Tim Fennell	BeeryRio	703-249-7668	<a href="mailto:tpfennell@beeryrio.com">tpfennell@beeryrio.com</a>
Bill Brown	BeeryRio	703-249-7640	<a href="mailto:bbrown@beeryrio.com">bbrown@beeryrio.com</a>

These meeting minutes reflect the notes and memory of the writer and constitute the basis on which the project is proceeding. Any clarifications, corrections, or additions should be submitted to BeeryRio in writing within seven days of receipt of this document.

<u>ITEM</u>	<u>DESCRIPTION</u>	<u>ACTION BY</u>
1.	Introductions were made and the committee was called to order at 3:45 pm.	-- --

<u>ITEM</u>	<u>DESCRIPTION</u>	<u>ACTION</u> <u>BY</u>
2.	The existing site constraints and previous concepts were reviewed by the committee. The four previous concepts from the last FAC meeting were review for historical background.	-- --



<u>ITEM</u>	<u>DESCRIPTION</u>	<u>ACTION</u> <u>BY</u>
3.	Mr. Fennell then discussed the new schemes based on comments received from the last FAC meeting. The first scheme, Scheme 2 presented has most of the public spaces on the left side of the site and the academic spaces primarily to the back and right of the site. The dumpster in each of the schemes proposed will be well screened. This scheme is further away from the property line at the right side than the existing building. The existing basketball court and large soft play area remain in the same approx. location as they are now.	-- --
4.	This layout helps to provide good sightlines from the street and administration area on the left of the site while extending the parking and the drop off loop. One concern that MCPS staff has with this scheme is the remoteness of circulation and the egress stair for the front wing is too remote. PEP and SCB are isolated from rest of academic wings.	-- --

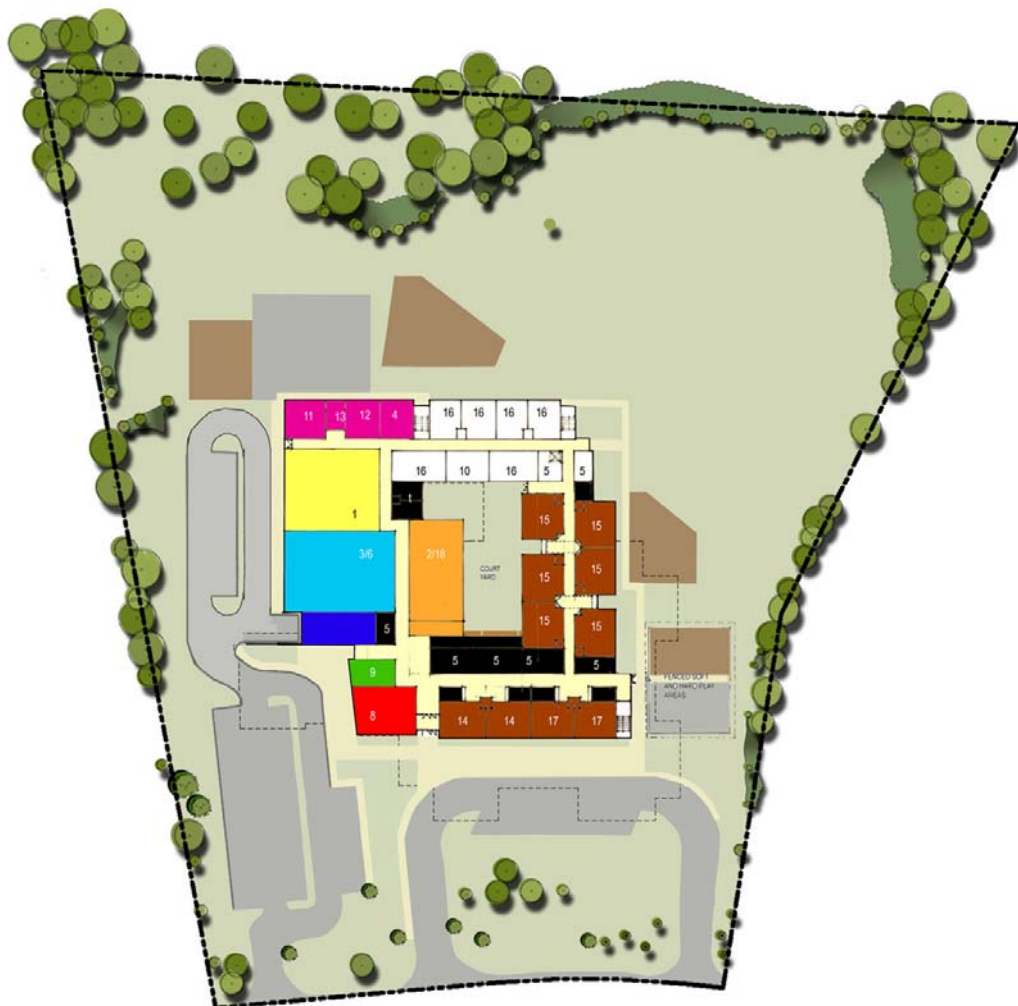

<u>ITEM</u>	<u>DESCRIPTION</u>	<u>ACTION</u> <u>BY</u>
5.	Mr. Fennell then moved on to present Scheme 3. The public spaces are located in a similar location to than shown in Scheme 2 except for the Media Center, which is located on the second floor in order to be closer to the classrooms.	-- --
6.	The major concern with this scheme is that the connecting corridor on the second floor is not very efficient. The second floor media is not conducive to community use. The breakout spaces do not have natural light. The drop off is extended for cuing. The central stair is helpful. One concern is more parking is needed.	-- --

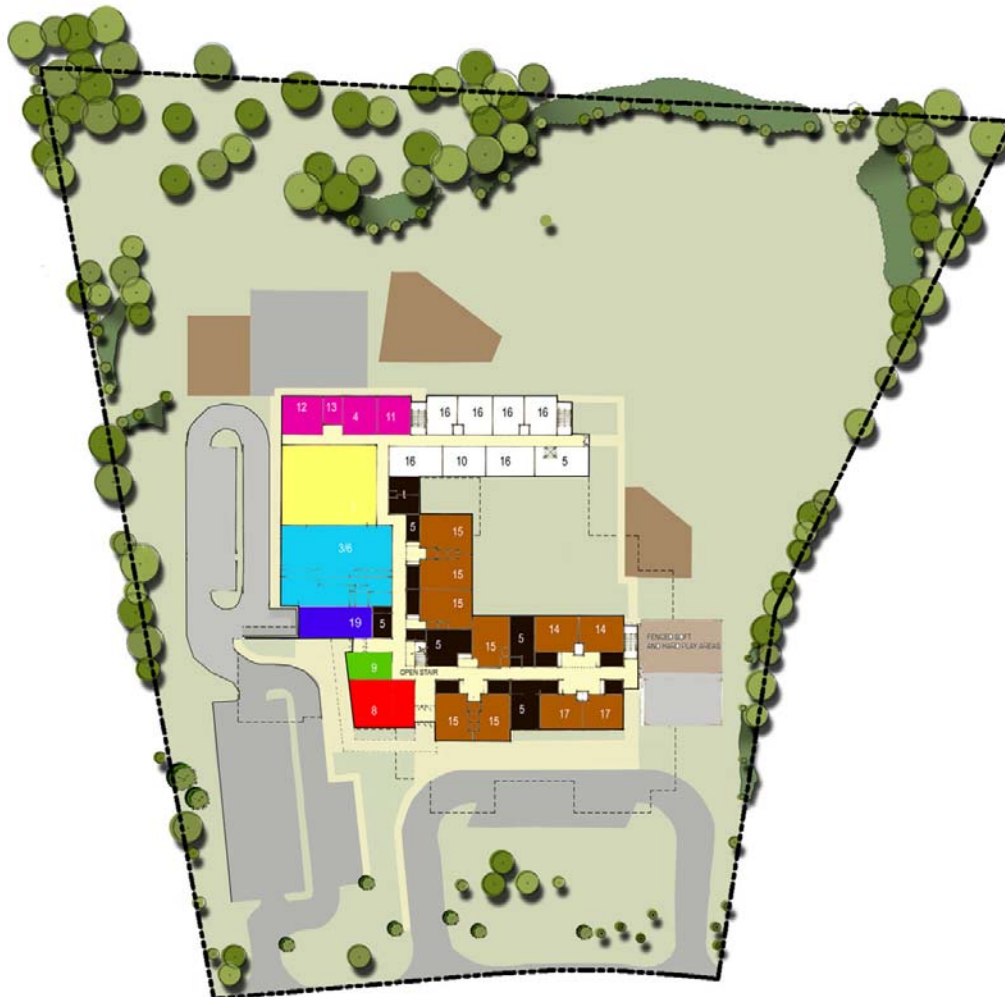

- |    |  |       |
|----|--|-------|
| 7. | Mr. Fennell then moved on to present Scheme 1. Scheme 1 is similar to the master plan for the modernization except that this scheme does have breakout spaces with natural light. PEP classrooms | -- -- |
|----|--|-------|

**ITEM    DESCRIPTION**

**ACTION  
BY**

are located on the right side of the school and Kindergarten classrooms are located on the left. The layout is focused around a large central courtyard with circulation looping around it. The purpose of the courtyard is to provide daylight to the classrooms. The courtyard does not add to the building footprint. This scheme is 15+/- feet closer to the property line on the right side than the existing building.

- |    |   |       |
|----|---|-------|
| 8. | The circulation in this scheme does make it easier to access administrative support spaces than the circulation in the existing building. This scheme allows for easy access to shared spaces like the gym and media center for after hours community use. The administrative support spaces to the front provide separation of truck/delivery from car traffic. Some additional staff parking should be provided off the bus loop. | -- -- |
|----|---|-------|



- |    |   |       |
|----|---|-------|
| 9. | In conclusion the preferred scheme voted on is 1 and will be presented to the PTA at the next | -- -- |
|----|---|-------|



**ITEM DESCRIPTION**

**ACTION  
BY**

meeting. Below is the pros and cons table.

1	65,882 sf	2	67,834 sf	3	70,015 sf
<b>pros</b>	<b>cons</b>	<b>pros</b>	<b>cons</b>	<b>pros</b>	<b>cons</b>
Keeps loading dock in existing location	building will sit closest to right side property line, MPR further from gym, PEP and SCB further from bus loop	MPR next to gym, more classrooms in rear wing so less isolation	two story academic wing next to neighbors	MPR next to gym, more classrooms in rear wing so less isolation	Open courtyard may be a safety concern, IMC upstairs
Good placement of stairs with one in front Admin corner		new rear entrance for student drop off, improve visibility for drop off loop	Only one stair in the front of the building, location away from admin corner	Good placement of stairs with one in front Admin corner	Isolation of PEP and SCB
maximizes parking		rebuild gym and locate it nearer to play areas,	Isolation of PEP and SCB	Open courtyard could provide more play area	media on second floor
new rear entrance for student drop off, improve visibility for drop off loop,		courtyard opportunities for outdoor learning (i.e. science gardens, butterfly garden, "green" teaching tools such as rain barrels, amphitheater, etc.),	PEP and SCB a long way to Gym, Music and Art	new rear entrance for student drop off, improve visibility for drop off loop,	long single loaded cooridor, on second floor inefficient and no circulation loop
rebuild gym and locate it nearer to play areas,		achieves small breakout areas throughout the classrooms		rebuild gym and locate it nearer to play areas,	
courtyard opportunities for outdoor learning (i.e. science gardens, butterfly garden, "green" teaching tools such as rain barrels, amphitheater, etc.),				courtyard opportunities for outdoor learning (i.e. science gardens, butterfly garden, "green" teaching tools such as rain barrels, amphitheater, etc.),	
media on first floor, optimum location for community use		media on first floor			media on second floor
achieves small breakout areas throughout the classrooms				achieves small breakout areas throughout the classrooms	

Tim Fennell, Principal, LEED AP