



March 9, 2022

A. *Introductions*



THE WEBINAR PROCESS...

This meeting is taking place as a Zoom **Webinar**.

Camera and microphone access will be limited to Panelists.

The presentation will be followed by A **Question and Answer Session**.

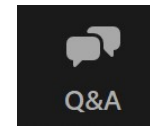

- Please save questions for this section
- Please click on the Question & Answer Icon to type in your questions.
- A host will read your question and a panelist will respond, as time allows.
- For further questions, contact **Jonathan_O_Acosta@mcpsmd.org**

Thank you for coming!

Agenda

- A. Introductions
- B. Goals + Flexibility of Space
- C. Phase 2 Building Design
- D. Phase 2 Site Design
- E. Schedule
- F. Q & A Session



B.

Goals + Flexibility of Space

- Provide Phase 2 program spaces, per Ed Specs
- Provide for program flexibility and the signature Arts Core program
- Provide seamless connections to Phase 1 building
- Integrate with site grading and Phase 1 site features, providing safe pedestrian, vehicle and service access
- Plan for an **efficient**, future masterplanned addition to add student capacity at a later time



OUR GOALS

- Deliver all **program spaces**, per Ed Specs
- Celebrate **student creativity** and expression through the arts, performance and innovation
- Create **flexible spaces** that support interdisciplinary project-based learning.
- Create **seamless connections** between Phase 1 + 2
- **Integrate site** design with grading and site features, providing safe pedestrian, vehicle and service access
- Plan for an **efficient masterplanned addition** to add student capacity at a later time



BUILDING USE - MODULES:

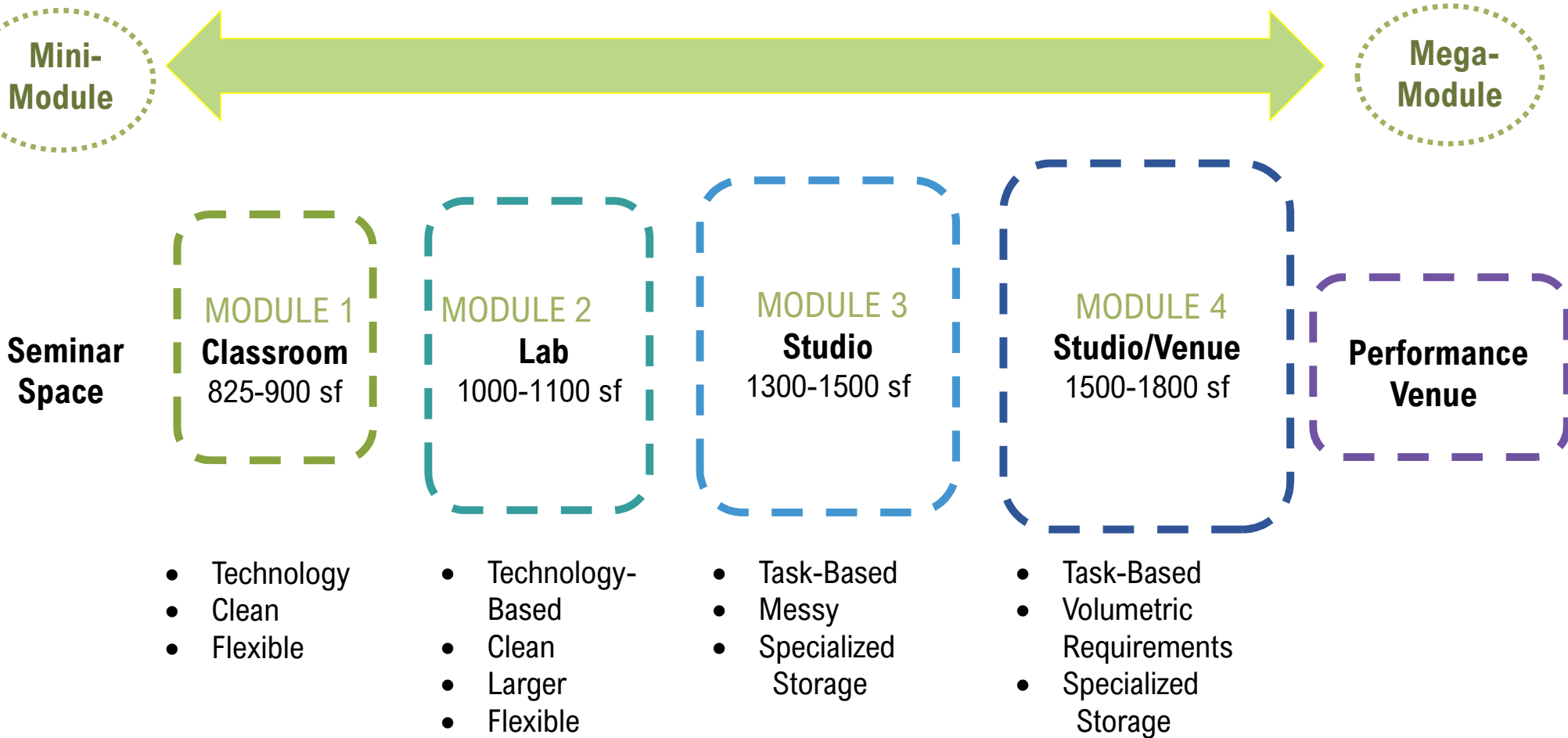

PHASE 2 BUILDING CHARACTER



VIEW FROM NORTHWEST

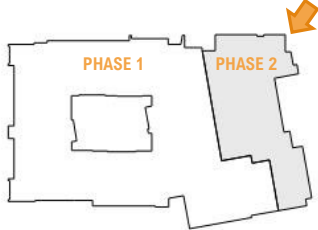

PHASE 2 BUILDING CHARACTER



WEST ELEVATION

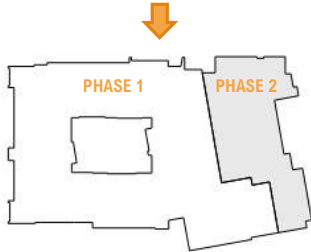

PHASE 2 BUILDING CHARACTER



VIEW FROM NORTHEAST

NORTH ELEVATION



PHASE 2 BUILDING CHARACTER

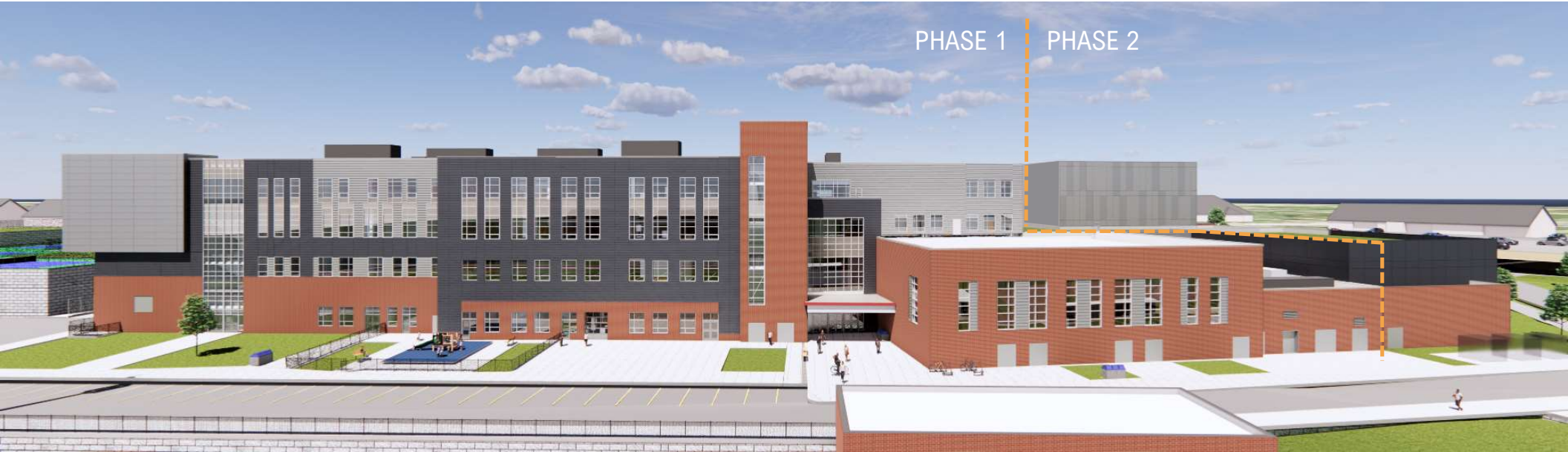

EAST ELEVATION

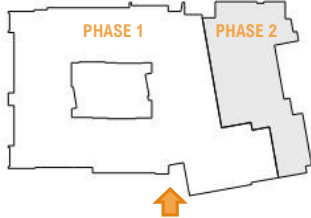

D. Site Design

- Maximize use for school-based programs
- Minimize retaining wall height and length
- Provide emergency and ADA access to each field
- Maintain regulation sizes of site amenities
- Minimize impact on Edson Lane Property



SITE GOALS

E. *Schedule*

- Provide school-based programs
- Minimize retaining wall height and length
- Provide emergency and ADA access to each field
- Maintain regulation sizes of site amenities
- Minimize impact on Edson Lane Property



WOODWARD PHASE 2 DESIGN SCHEDULE

3/22 4/22 5/22 6/22 7/22 8/22 9/22 10/22 11/22



3/09

Community Engagement Mtg.



4/07

BOE Mtg.

SCHEMATIC DESIGN



DESIGN DEVELOPMENT



CONSTRUCTION DOCUMENTS



March

April

May

June

July

August

September

October

November

2022

WOODWARD PHASE 2 SCHEDULE

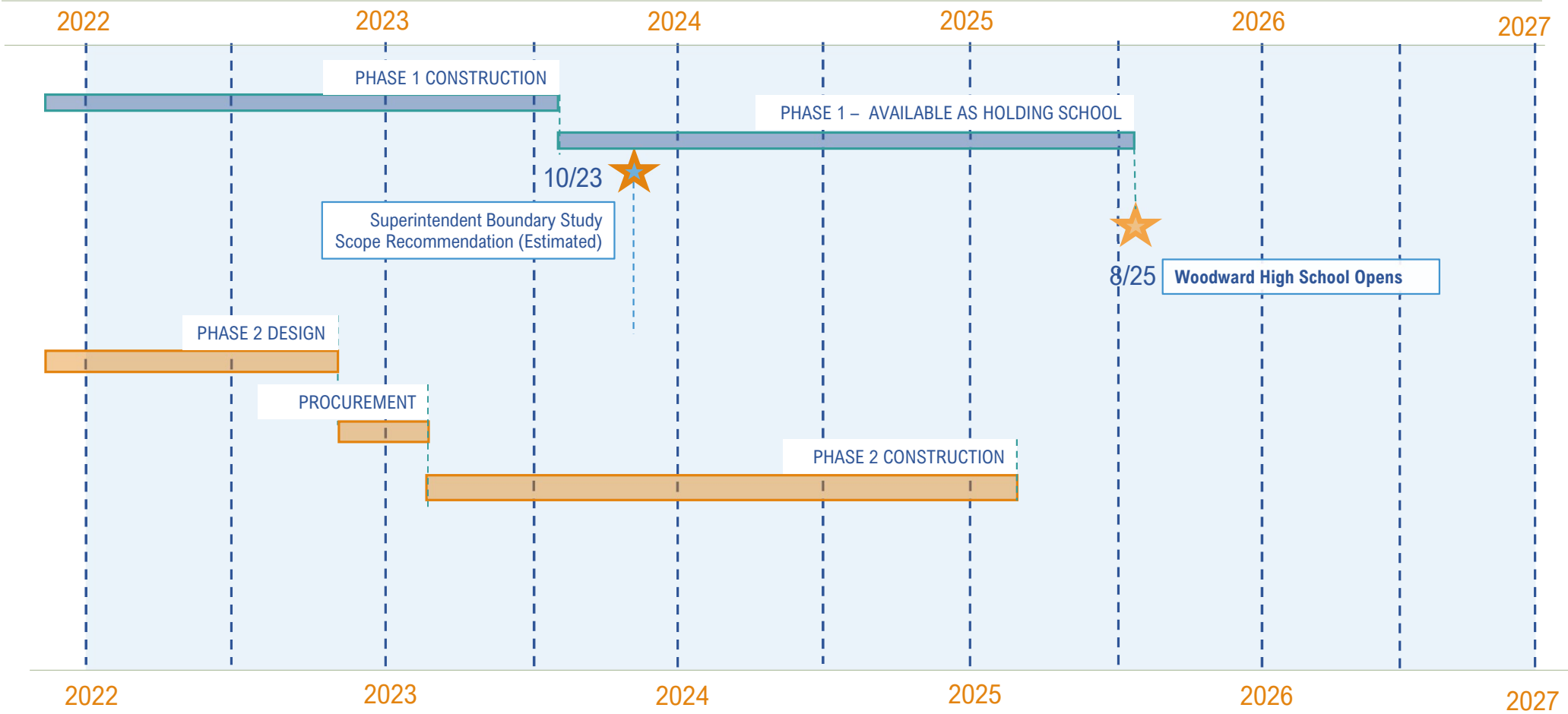

*Reference response to question #6 on meeting notes for information regarding potential impact of final approved County Capital Improvements Budget.

SITE GOALS

F. Questions & Answers

- Provide school-based programs
- Minimize retaining wall height and length
- Provide emergency and ADA access to each field
- Maintain regulation sizes of site amenities
- Minimize impact on Edson Lane Property



